

THIS COPY IS PROVIDED ON A RESTRICTED BASIS AND IS NOT TO BE USED IN ANY WAY DETRIMENTAL TO THE INTERESTS OF PANDUIT CORP.

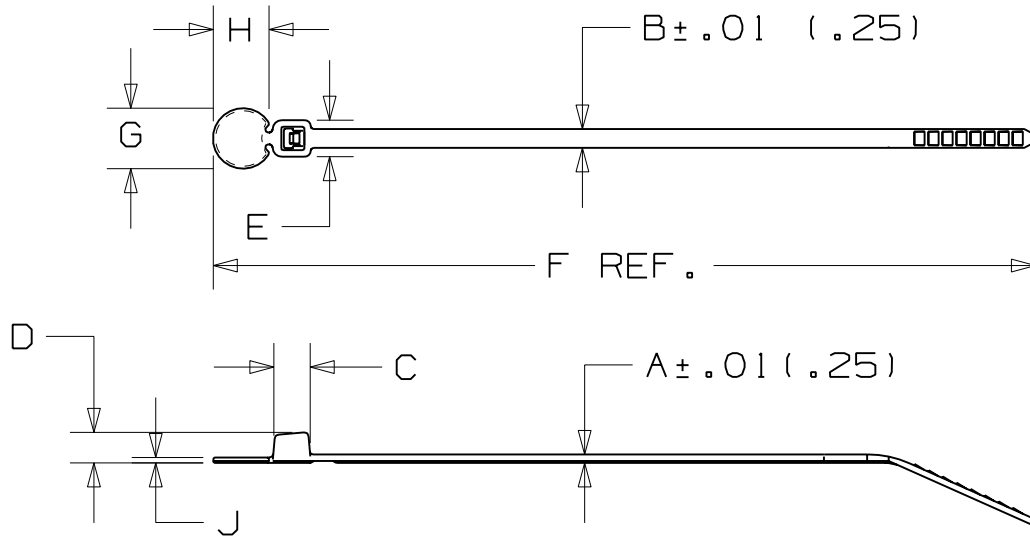

PANDUIT PART NO. *	BUNDLE DIA.		A in (mm)	B in (mm)	C in (mm)	D in (mm)	E in (mm)	F in (mm)	G in (mm)	H in (mm)	J in (mm)	WRITE-ON AREA in (mm)	MIN. LOOP TENSILE lbs (N)	CROSS SECTION	WEIGHT lbs/100 pcs. (g)
	MIN. in (mm)	MAX. in (mm)													
PLF1MC	.06 (1.5)	.87 (22.0)	.045 (1.1)	.098 (2.5)	.177 (4.5)	.154 (3.9)	.180 (4.6)	4.3 (109)	.315 (8.0)	.290 (7.4)	.038 (.96)	.064 (1.626)	18 (80)	MINIATURE	.07 (31.8)

DIMENSIONS IN PARENTHESES ARE IN METRIC UNITS

PANDUIT CORP. TINLEY PARK, ILLINOIS

PLF1MC CABLE TIE

UNLESS OTHERWISE SPECIFIED,  
DIMENSIONAL TOLERANCES ARE:  
(.X) ± .01 (.25) (.XXX) ± .020 (.50)  
(.XX) ± .02 (.5) ANGLES ± \_\_\_\_\_

UNLESS OTHERWISE SPECIFIED,  
ALL DIMENSIONS ARE GIVEN  
IN INCHES, THIRD ANGLE PROJECTION.

DRAWN BY  
RAMA

MAT'L:

SCALE  
NONE

DATE  
6/23/05

NYLON 6.6

DRAWING NO.

SS-27445

DWG  
A  
SIZE

REV	DATE	BY	CHK	DESCRIPTION	ECN	R	CUST	SUP
3	5/02/06	FAB		CHANGED DIM. J FROM .028" TO .038"	27445		3	